

**SERVICE PARTS INFORMATION
FOR
COMMERCIAL DOOR OPERATOR
MODEL PD-12**

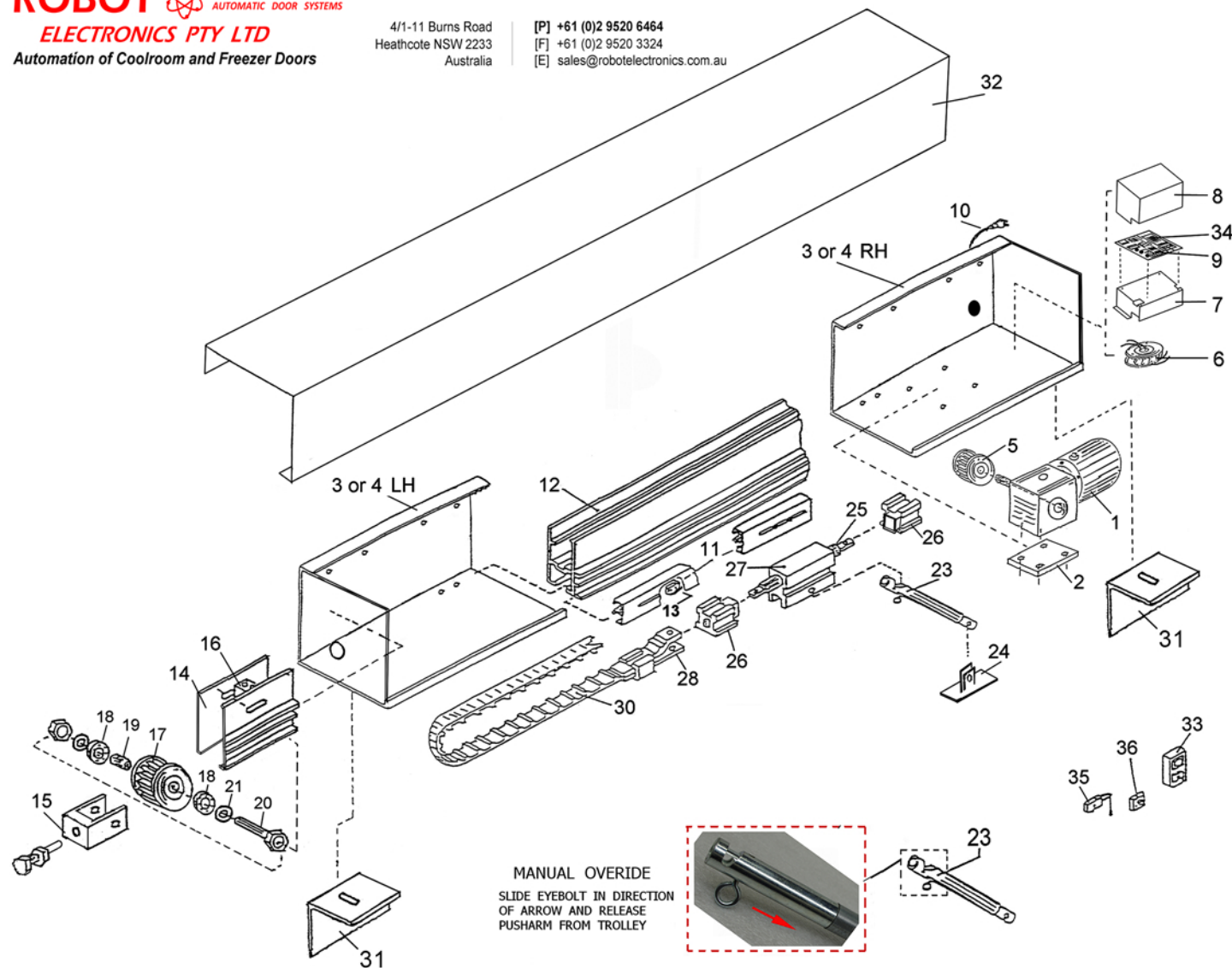

1	Motor 24VDC GR63X25 or GR63X55 WITH Gearbox SG 00
2	Motor spacer
3	Base plate, LH or RH 450mm long
4	Base plate, LH or RH 330mm long
5	Drive pulley 5M
6	Transformer, Toroidal 18VAC, 80VA
7	Transformer cover, LH or RH
8	PCB cover, LH or RH
9	PC Board
10	240V power lead
11	Reed switch channel rail
12	Drive channel drilled per meter
13	Reed Switch
14	Adjuster housing
15	Adjuster complete with 3/8" bolt
16	Adjuster block
17	Idler pulley 5M
18	Idler bearing each
19	Spacer
20	Idler pulley shaft with M12 nut & 2x washers
21	Washer (set of 4)
23	Release arm (specify length)
24	Door Bracket (specify door thickness)
25	Link Shaft
26	Guide Block (2x required per opener)
27	Trolley
28	Belt joiner with M6 bolt (2x required per opener)
30	Belt 5M per meter
31	Mounting bracket each
32	Pelmet cover (specify length)
33	Transmitter Single Channel FMT-401 or MCT91501
34	Receiver strip FMR-201 or MCR-915
35	Pull cord switch
36	Pedestrian push button

MANUAL OVERRIDE
SLIDE EYEBOLT IN DIRECTION
OF ARROW AND RELEASE
PUSHARM FROM TROLLEY

